

Description

Comrod produces a large range of dipole antennas suitable for mounting on vehicles, shelters and elevating on masts. Dipole antennas do not require a groundplane so are particularly suited to elevating on a support mast. To enable deployment across all tactical and fixed platforms, Comrod has a large range of antenna bases and mounting adaptors.

Antenna element to base connector

Comrod dipole antennas are supplied with either a Comrod VM or CEF type connection between the antenna element and base/mounting (see Fig 3). The connection shares the same size mounting thread but has a different internal RF contact. Antennas with an upper frequency of around 450MHz use the VM connector shown in Fig 1a/b. Antennas with an upper frequency above 450MHz use the CEF type connector shown in Fig 2a/b. Both of these connectors are proprietary to Comrod.

VM Connector



Fig 1a - VM Connector
Base/Adaptor



Fig 1b - VM Connector
Antenna Element

CEF Connector



Fig 2a - CEF Connector
Base/Adaptor

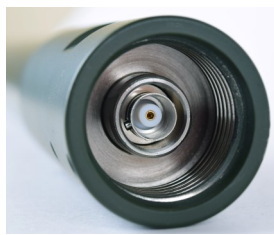

Fig 2b - CEF Connector
Antenna Element

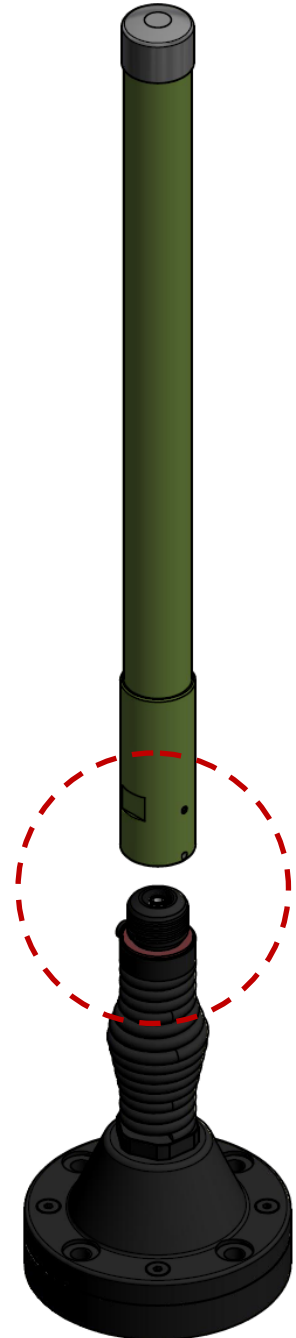

Fig 3 - Antenna to
base connection

Vehicle and Shelter Bases (VM Connector)



Bases VM-A, VM-B, VM-C & VM-D are also available with optional NATO 6-hole pattern - 6 x M6 or 1/4" Bolts on 111mm (4.37in) PCD



Mounting Adaptors (VM Connector)

VM-H



General Purpose
Bulkhead Adaptor
Mounting hole diameter
22mm (0.87in)

VM-J

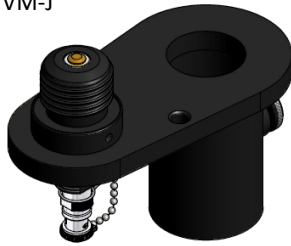

Mast Mount Bracket
40mm (1.57in) Socket
42mm (1.65in) Socket
50mm (1.97in) Socket
Comrod AMX85 Mast
Comrod ULM48 Mast
Customer Specified

VM-K



Mast Mount Bracket
24mm (0.94in) Spigot
40mm (1.57in) Spigot
50mm (1.97in) Spigot
Customer Specified

VM-L



AMX85 Mast Mount Bracket
To fit Comrod AMX85 mast
sections

VM-M



Pole Mount Adaptor
Pole diameter 14-62mm (0.55-2.44in)
Vertical or horizontal mount
N-type female bottom connector

VM-N

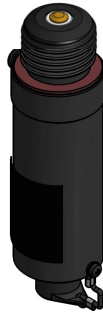

Tube Clamp Adaptor
Clamp area diameter 38mm (1.5in)
Clamp area length 80mm (3.2in)
N-type female bottom connector

VM-P

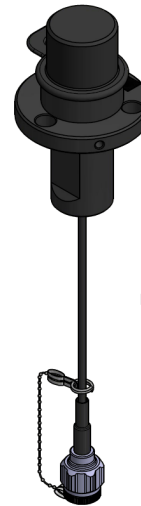

RolaTube Mast Antenna VM Adaptors
Fits standard RolaTube 30mm socket
N-type female or male connector versions

Comrod dipole antennas with VM connector

The following table shows a small selection of Comrod dipole antenna elements suitable for use with the VM bases and mounting adaptors.

Comrod also produces a range multiband antennas which can be a combination of dipole and monopole construction. The monopole part of these antennas will require a groundplane to operate correctly. Most of the vehicle and shelter bases can be used if mounted on a suitable groundplane. Comrod has a range of mounting solutions to elevate monopole and combined monopole/dipole antennas using a groundplane tripod or groundplane guy wires.

Please contact Comrod for further information.

Antenna	Description	Connection
VHF3088VM	30-88 MHz	VM
VHF30108VM	30-108 MHz	VM
VHF108185VM	108-185 MHz	VM
UHF225450VM-HG	225-450 MHz	VM
UHF225512VM-HG	225-512 MHz	VM

Vehicle and Shelter Bases (CEF Connector)

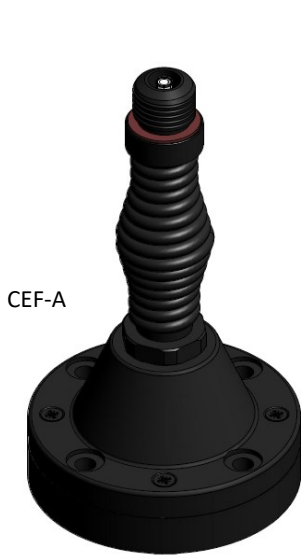

NATO 4-hole Spring
4 x M10 or 3/8" Bolts
on 114mm 4.5in) PCD
Base diameter 140mm (5.5in)
Base height 240mm (9.5in)

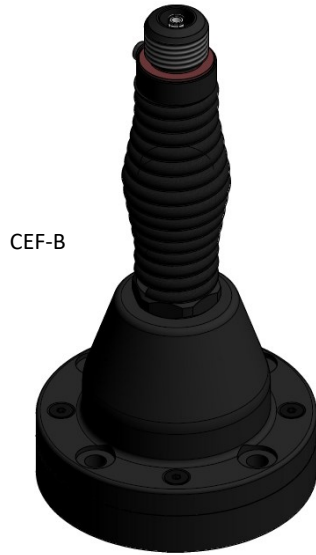

NATO 4-hole Spring GPS
4 x M10 or 3/8" Bolts
on 114mm (4.5in) PCD
Base diameter 140mm (5.5in)
Base height 280mm (11in)



NATO 4-hole Rigid
4 x M10 or 3/8" Bolts
on 114mm (4.5in) PCD
Base diameter 140mm (5.5in)
Base height 100mm (4in)



NATO 4-hole Rigid
4 x M10 or 3/8" Bolts
on 114mm (4.5in) PCD
Base diameter 140mm (5.5in)
Base height 125mm (5in)

Bases CEF-A, CEF-B, CEF-C & CEF-D are also available with optional NATO 6-hole pattern - 6 x M6 or 1/4" Bolts on 111mm (4.37in) PCD



NATO
50mm Thread
Base diameter 95mm (3.74in)

Mounting Adaptors (CEF Connector)

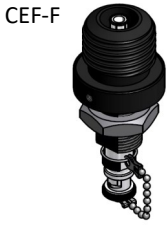

CEF-F
General Purpose
Bulkhead Adaptor
Mounting hole diameter
22mm (0.87in)

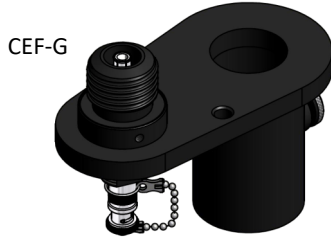

CEF-G
Mast Mount Brackets
40mm (1.57in) Socket
42mm (1.65in) Socket
50mm (1.97in) Socket
Comrod AMX85 Mast
Comrod ULM48 Mast
Customer Specified

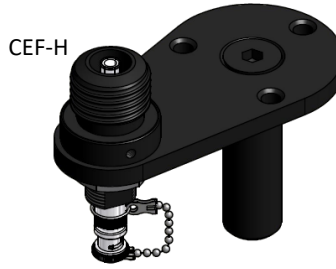

CEF-H
Mast Mount Bracket
24mm (0.94in) Spigot
40mm (1.57in) Spigot
50mm (1.97in) Spigot
Customer Specified

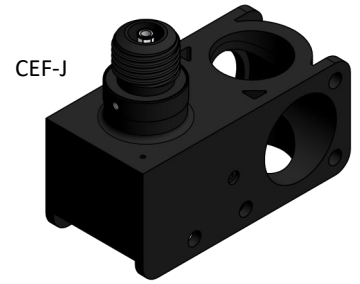

CEF-J
AMX85 Mast Mount Bracket
To fit Comrod AMX85 mast sections

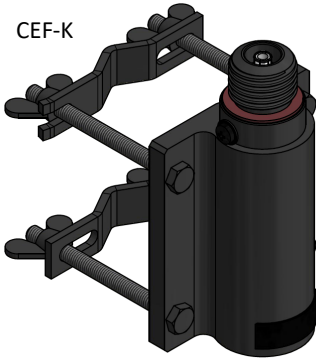

CEF-K
Pole Mount Adaptor
Pole diameter 14-62mm (0.55-2.44in)
Vertical or horizontal mount
N-type female bottom connector

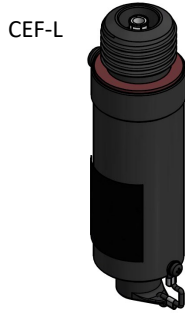

CEF-L
Tube Clamp Adaptor
Clamp area diameter 38mm (1.5in)
Clamp area length 80mm (3.2in)
N-type female bottom connector

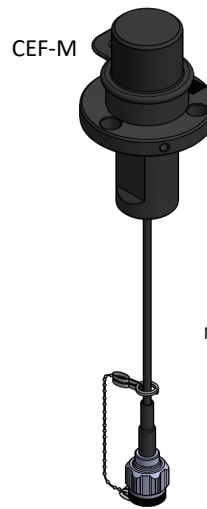

CEF-M
RolaTube Mast CEF Antenna Adaptors
Fits standard RolaTube 30mm socket
N-type female or male connector versions

Comrod dipole antennas with CEF connector

The following table shows a small selection of Comrod dipole antenna elements suitable for use with the CEF bases and mounting adaptors.

Comrod also produces a range multiband antennas which can be a combination of dipole and monopole construction. The monopole part of these antennas will require a groundplane to operate correctly. Most of the vehicle and shelter bases can be used if mounted on a suitable groundplane. Comrod has a range of mounting solutions to elevate monopole and combined monopole/dipole antennas using a groundplane tripod or groundplane guy wires.

Please contact Comrod for further information.

Antenna	Description	Connection
VHF100512VM	100-512 MHz	CEF
UHF400512VM	400-700 MHz	CEF
UHF2252000DB	225-450, 1200-2000 MHz	CEF
UHF2252000VM	225-2000 MHz	CEF
UHF630VM	600-3000 MHz	CEF
UHF720VM-HG	700-2000 MHz	CEF
UHF727VM-DB-HG	690-960, 1700-2700 MHz	CEF
UHF727VM	700-2700 MHz	CEF
UHF710VM-HG	700-1000 MHz	CEF
UHF1227VM	1200-2700 MHz	CEF
UHF2450VM-8	2400-2500 MHz	CEF
UHF243380S	243-380 MHz	CEF