

- 2-30 MHz
- 400 W CW
- Folded dipole elements with 300 ohm balanced feed
- Permits fast frequency shifting as it does not require any adjustments
- Easy to erect and dismantle
- Can be supported on any suitable 5-9m (16-30 ft) tall non-conducting support structure
- Kit includes locking guy ring for use on Comrod AMX85 man-portable support mast
- Can be combined with other Comrod elevated antennas and mast kits

Electrical Specification

Frequency range	2-30 MHz
Nominal impedance	300 Ω - balanced transmission line
Power rating	400 W
Radiation pattern	Omnidirectional (nominal)
Polarization	Horizontal

Mechanical Specification

Design	Broadband dipole wire antenna
Connector	2 x hook terminals
Weight	3.5 lbs (1.6 kg)
Temperature range	-67°F to +160°F, -55°C to +71°C

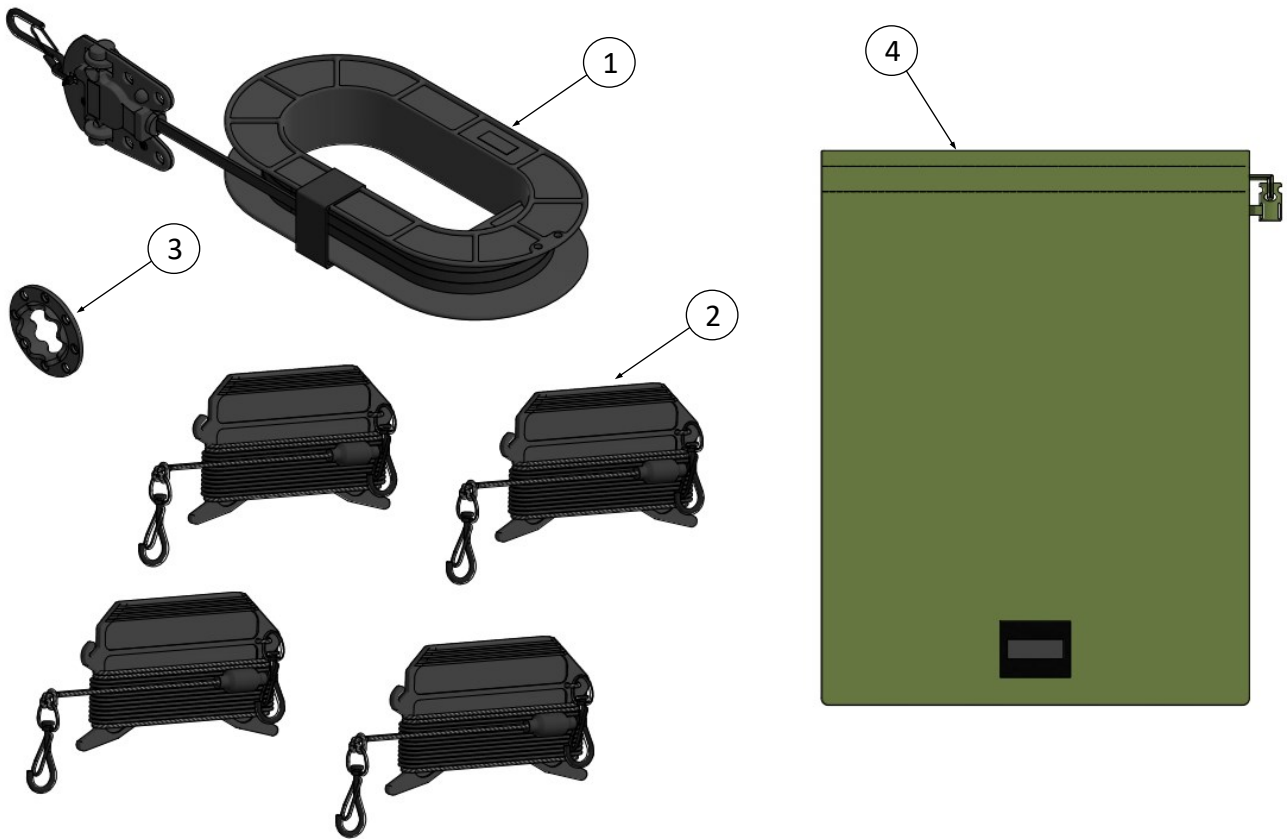

Center junction and dipole wires
(shown with optional AMX85 support mast)

Kit List

Part	Item	Qty
HF center junction and feed cable	1	1
HF dipole element on winder	2	4
Guy ring locking (AMX85)	3	1
Carrying bag	4	1
User manual	-	1

